

**NOTES:**

1. TOPOGRAPHIC CONTOUR INTERVALS ARE 10 FEET. DATUM IS MEAN SEA LEVEL ELEVATION.
2. THE AERIAL CONTOURS ILLUSTRATE THE HEIGHT LIMITATIONS WITHIN EACH ZONE.
3. A SLOPE SUCH AS 40:1, EXPRESSES THE HORIZONTAL DISTANCE OF 40 FEET TO THE VERTICAL DISTANCE OF 1 FOOT.
4. EXISTING TOPOGRAPHIC SYMBOLS ARE THOSE USED BY THE U.S. GEOLOGICAL SURVEY.
5. IN THOSE AREAS WHERE EXISTING TERRAIN OR TREES PENETRATE ONE OR MORE OF THE IMAGINARY SURFACES THE HEIGHT OF STRUCTURES SHALL BE RESTRICTED ONLY TO THE HEIGHT OF THE TREE CANOPY WHICH PROVIDES A NATURAL SHIELD TO THE STRUCTURE.

**LEGEND**

ULTIMATE RUNWAY	
ZONE BOUNDARY	
TOPOGRAPHIC CONTOURS	1200
AERIAL CONTOURS	1400
SECTION LINES	

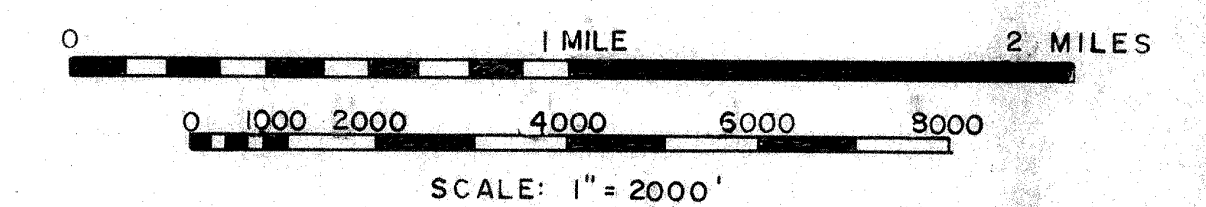

**HAWLEY MUNICIPAL AIRPORT  
ZONING PLAN  
HAWLEY, MINNESOTA**

STATE AIRPORT ZONING BOARD

APPROVAL _____	DATE _____
APPROVAL _____	DATE _____
APPROVAL _____	DATE _____

REVISIONS		
NO.	DESCRIPTION	DATE

I HEREBY CERTIFY THAT THIS PLAN, SPECIFICATION OR REPORT WAS PREPARED BY ME OR UNDER MY DIRECT SUPERVISION AND THAT I AM A DULY REGISTERED ENGINEER UNDER THE LAWS OF THE STATE OF MINNESOTA.

NAME Jessie D. Balken DATE 9-16-83 REG. NO. 12021

**LARSON-PETERSON & ASSOC., INC.**  
CONSULTING ENGINEERS  
DETROIT LAKES, MINNESOTA

DRAWN BY: J.A.G.  
CHECKED BY: \_\_\_\_\_  
APPROVED BY: \_\_\_\_\_  
REVISED BY: \_\_\_\_\_

SHEET 1 OF 3 SHEETS  
DATE AUGUST, 1983  
FILE NO. 83-H-8

DRAWN BY: J.A.G. DATE: 9-16-83 REG. NO. 12021

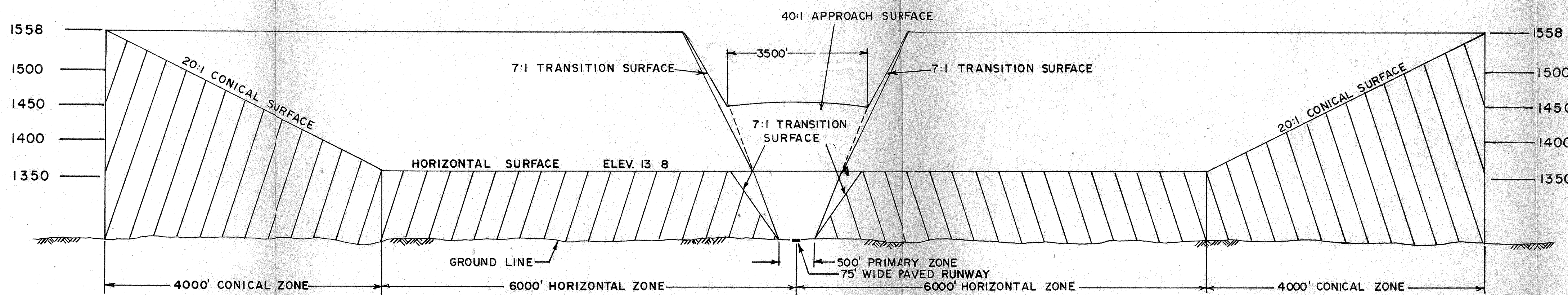

SECTION B-B  
(NOT TO SCALE)

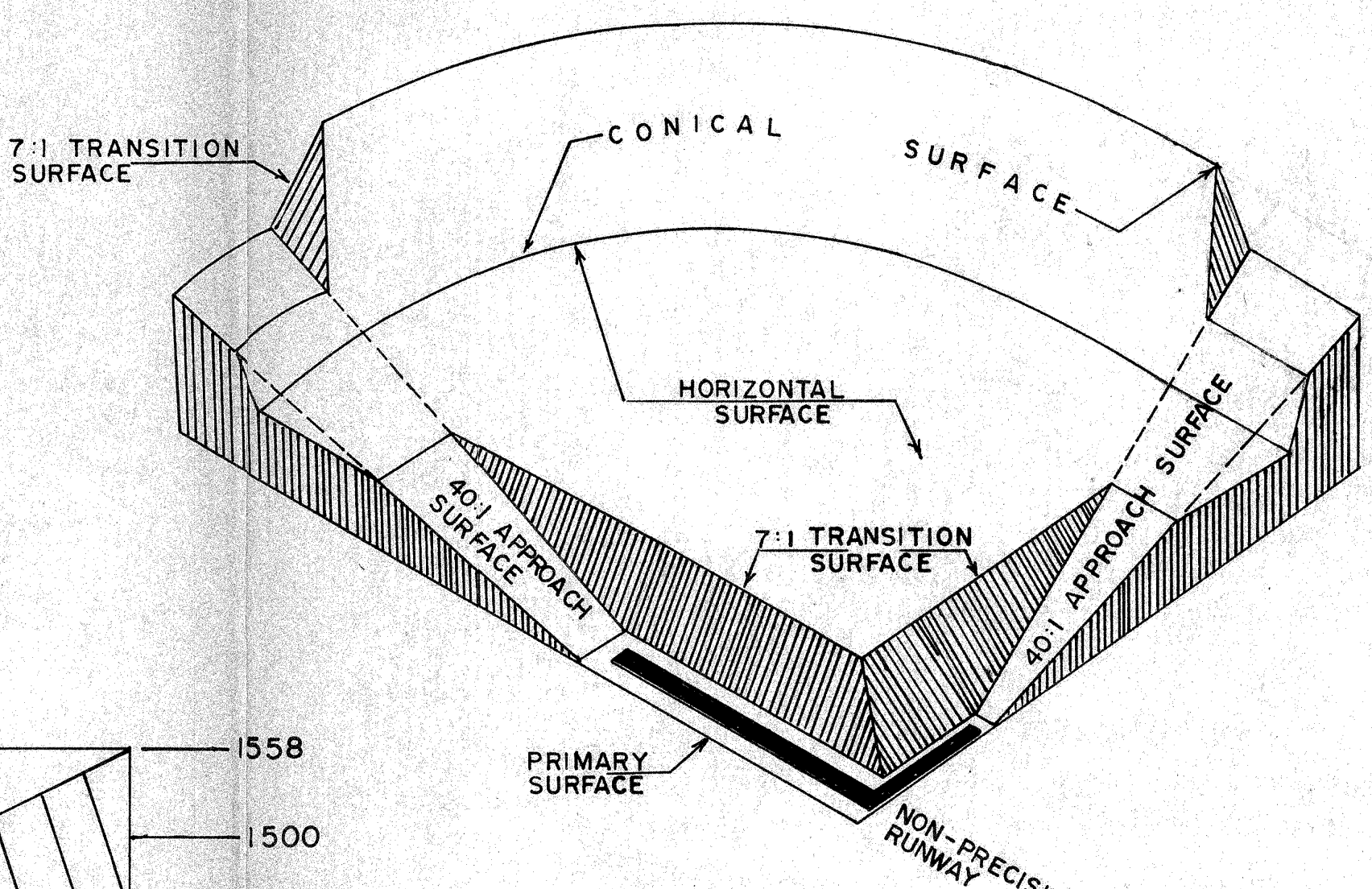

PERSPECTIVE VIEW SHOWING  
IMAGINARY SURFACES

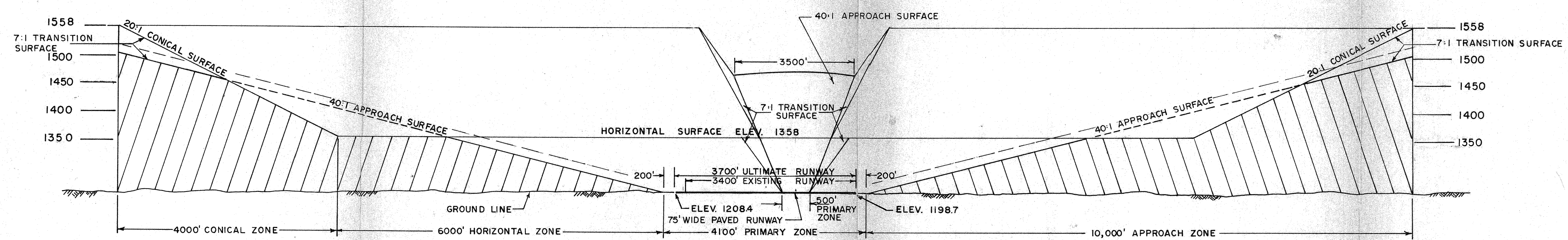

SECTION A-A  
(NOT TO SCALE)

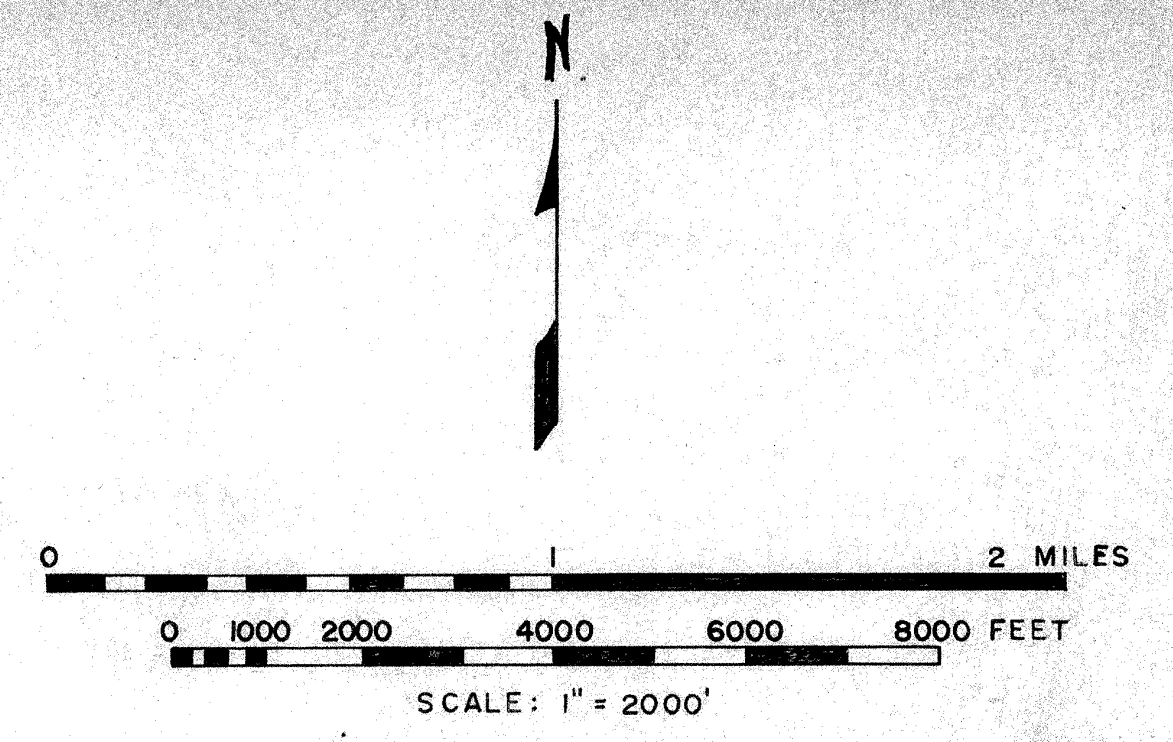
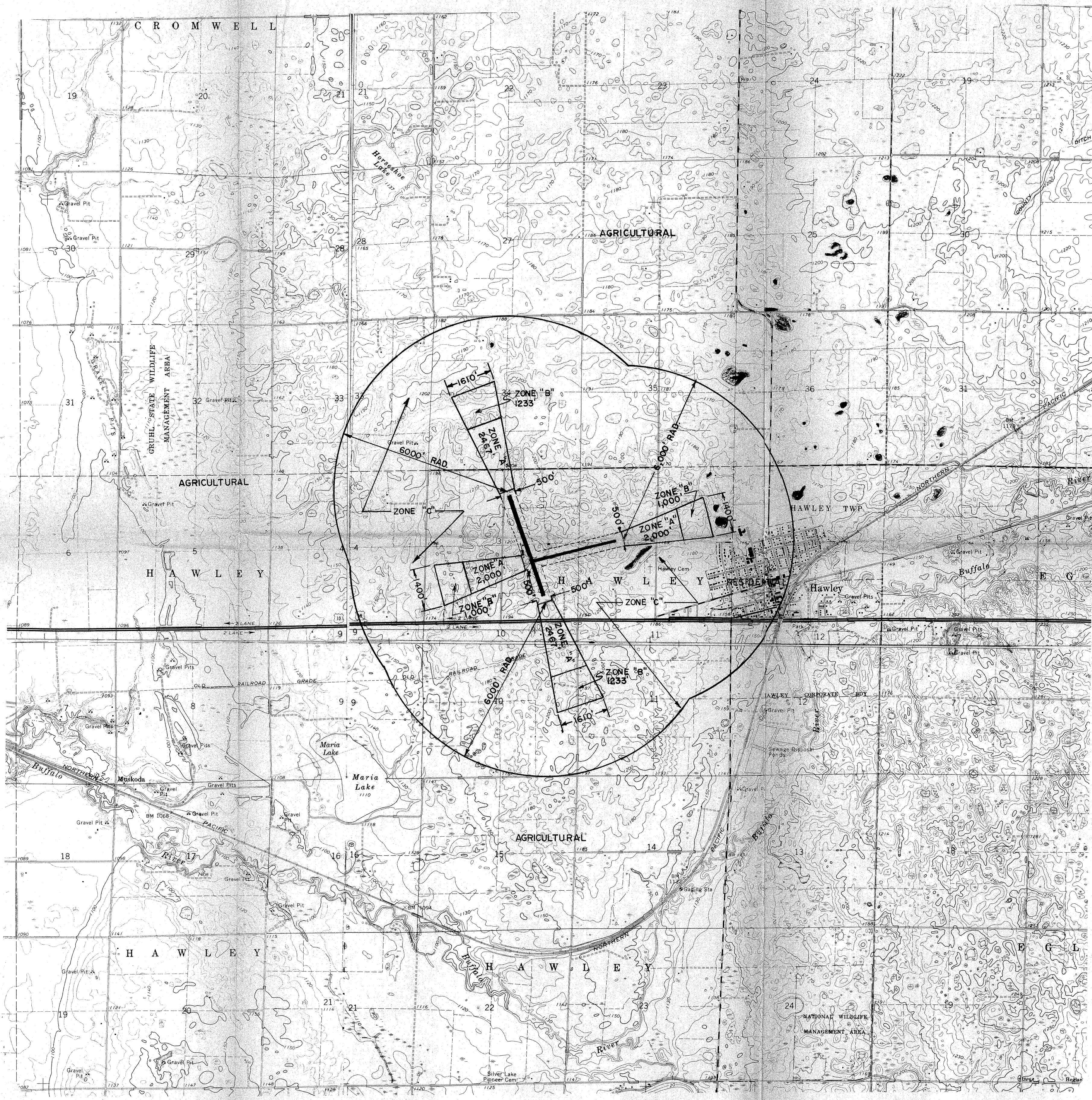

**LEGEND**

- ULTIMATE RUNWAY
- ZONE BOUNDARY
- TOPOGRAPHIC CONTOURS 1200
- SECTION LINES

**NOTES:**

1. TOPOGRAPHIC CONTOUR INTERVALS ARE 10 FEET. DATUM IS MEAN SEA LEVEL ELEVATION.
2. EXISTING TOPOGRAPHIC SYMBOLS ARE THOSE USED BY THE U.S. GEOLOGICAL SURVEY.
3. EXISTING LAND USE IS AS SHOWN.